

VENT-AXIA SCEPTRE SLIM CASE AXIAL FANS FAN DIMENSIONS (mm)

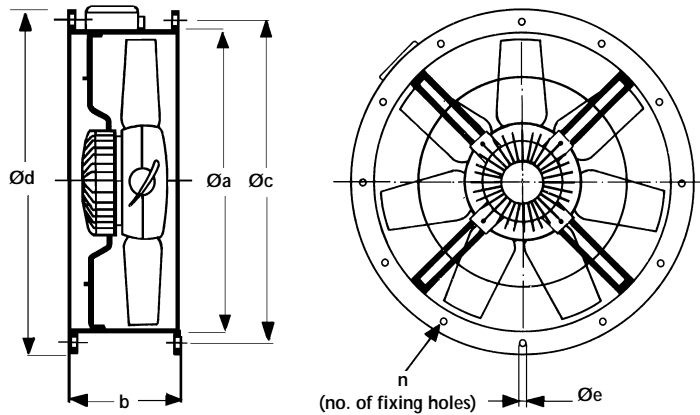

size	Øa	b	Øc	Ød	Øe	n	kg approx
250	254	170	292	327	10	4	6.8
315	315	170	355	386	10	8	9.9
355	355	170	395	426	10	8	11.9
400	400	170	450	487	12	8	13.8
450	450	180	500	537	12	8	18.1
500	500	180	560	595	12	12	21.9
560	560	240	620	655	12	12	30.2
630	630	240	690	725	12	12	34.7
710-4	710	350	770	806	12	16	54
710-6	710	240	770	806	12	16	46
800	800	350	860	896	12	16	89

TYPICAL INSTALLATION

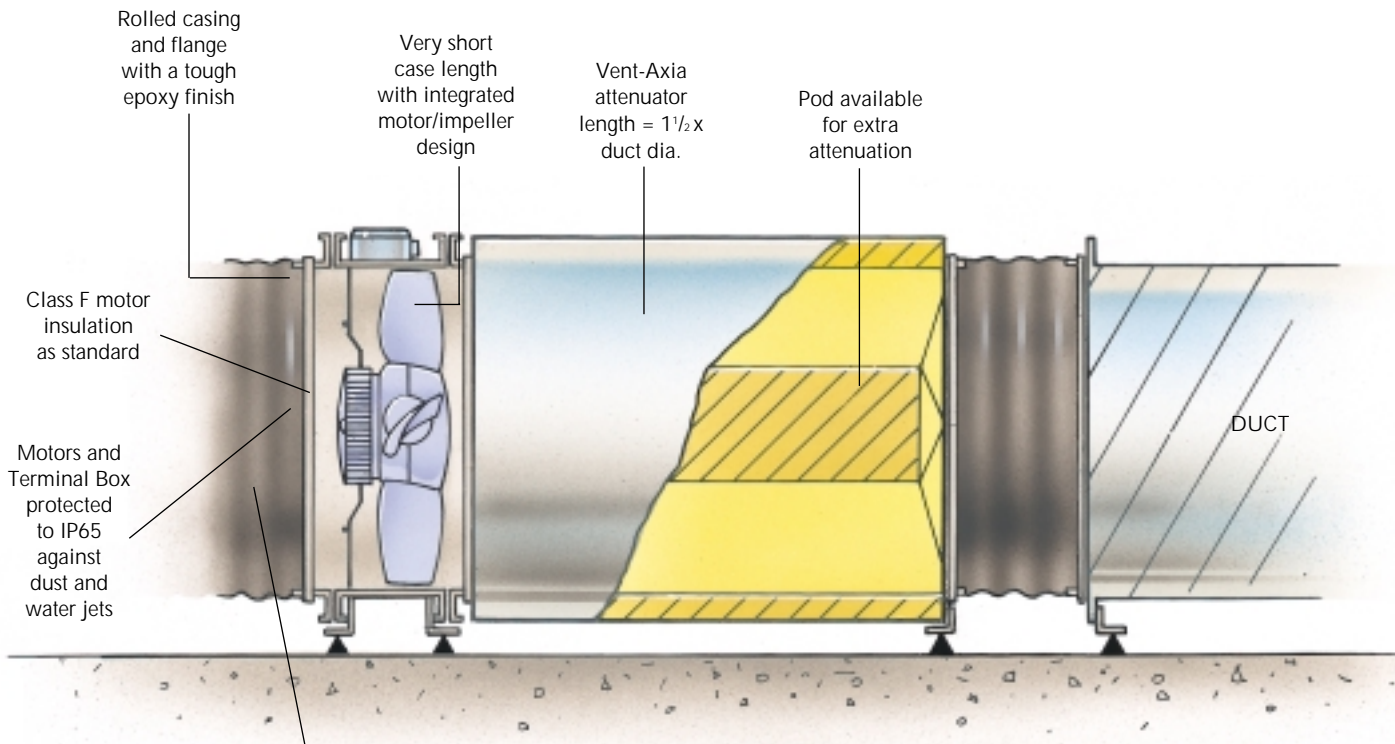

Case axial ancillary pack consists of 2 matching flanges, 2 flexible connections, 2 mounting feet, 4 anti-vibration mounts and 4 worm drive clips

SCEPTRE SLIM CASE AXIAL FANS ACCESSORIES (mm)

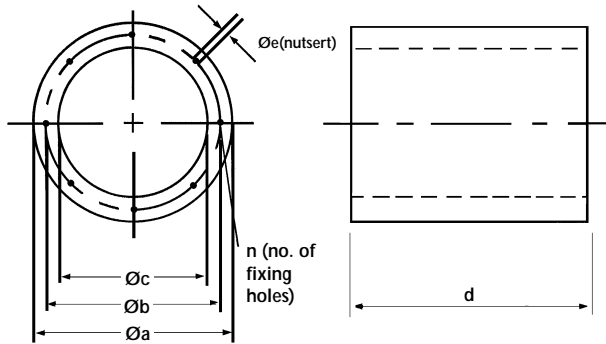

RESISTANCE GRAPH FOR CASE ATTENUATOR FITTED WITH POD

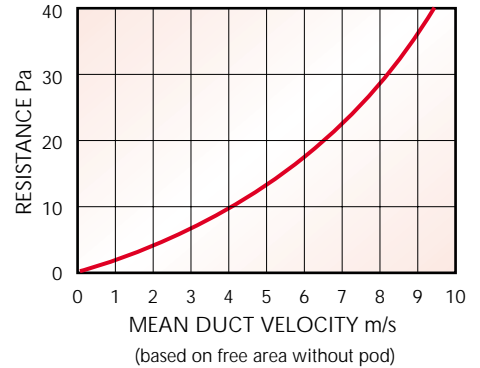

CASE AXIAL ATTENUATOR

Stock Ref. No.	Øa	bØ	Øc	d	Øe*	n	kg approx	Fitted with pod kg approx	Free area m ² without pod
105 14 250	350	292	250	375	M10	4	8	13	0.04909
105 14 315	415	355	315	475	M8	8	22	32	0.07793
105 14 355	455	395	355	540	M8	8	30	44	0.09898
105 14 400	500	450	400	600	M10	8	41	60	0.12566
105 14 450	550	500	450	675	M10	8	50	73	0.15904
105 14 500	600	560	500	750	M10	12	59	87	0.19635
105 14 560	660	620	560	840	M10	12	70	102	0.24630
105 14 630	730	690	630	940	M10	12	82	120	0.31172
105 14 710A	814	770	710	1070	M10	16	90	134	0.39597
105 14 800A	900	860	800	1200	M10	16	100	149	0.50272

*Threaded hole to take bolt

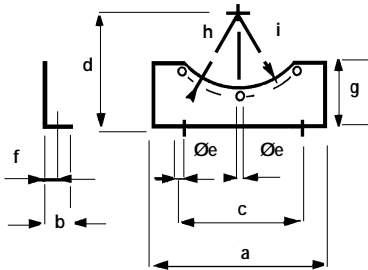

MOUNTING FEET

Stock Ref. No.	a	b	c	d	Øe	f	g	h	i
105 03 250	232	24	180	200	10	14	115	146	130
105 03 315	275	24	224	224	10	14	115	177.5	167
105 03 355	303	24	250	250	10	14	125	197.5	187
105 03 400	348	24	280	280	12	14	135	225	213
105 03 450	384	24	315	315	12	14	155	250	238
105 03 500	425	24	315	315	12	14	135	280	268
105 03 560	475	24	355	355	12	14	155	310	298
105 03 630	520	24	400	400	12	14	175	345	333
105 03 710A	710	40	610	435	12	18	240	385	365
105 03 800A	810	40	700	480	12	18	262	430	410

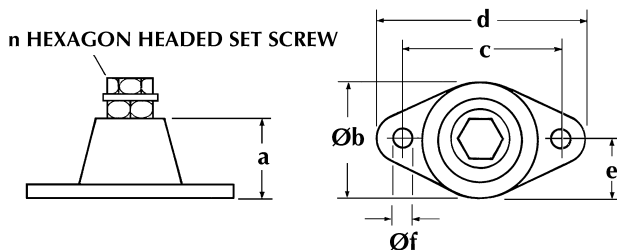

ANTI-VIBRATION MOUNTS

Stock Ref. No.	a	Øb	c	d	e	Øf	n	Max load kg
105 23 033	27	37	54	67	18.5	7	M8	23
105 23 055	27	37	54	67	18.5	7	M8	36
105 23 133	35	57	76	95	28.5	10.5	M12	91

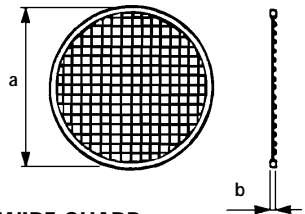

INLET WIRE GUARD

'K' factor loss 0.25

Stock Ref. No.	Øa	b
105 05 250	305	3
105 05 315	380	3
105 05 355	420	3
105 05 400	475	3
105 05 450	525	3
105 05 500	595	3
105 05 560	655	3
105 05 630	725	3
105 05 710	784	10
105 05 800	870	10

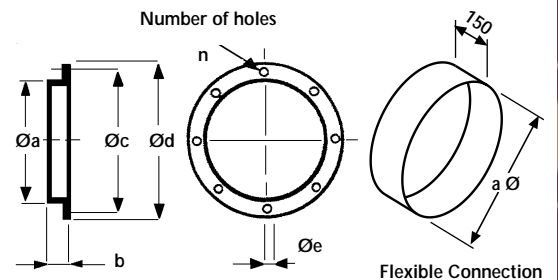

COUPLING FLANGE

Stock Ref. No.	Øa	b	Øc	Ød	Øe	n
105 06 250	250	55	292	323	10	4
105 06 315	315	30	355	386	10	8
105 06 355	355	45	395	426	10	8
105 06 400	400	45	450	487	12	8
105 06 450	450	60	500	537	12	8
105 06 500	500	60	560	595	12	8
105 06 560	560	75	620	655	12	12
105 06 630	630	75	690	725	12	12
105 06 710A	710	40	770	794	13	16
105 06 800A	800	40	860	884	13	16